

# Case Stories

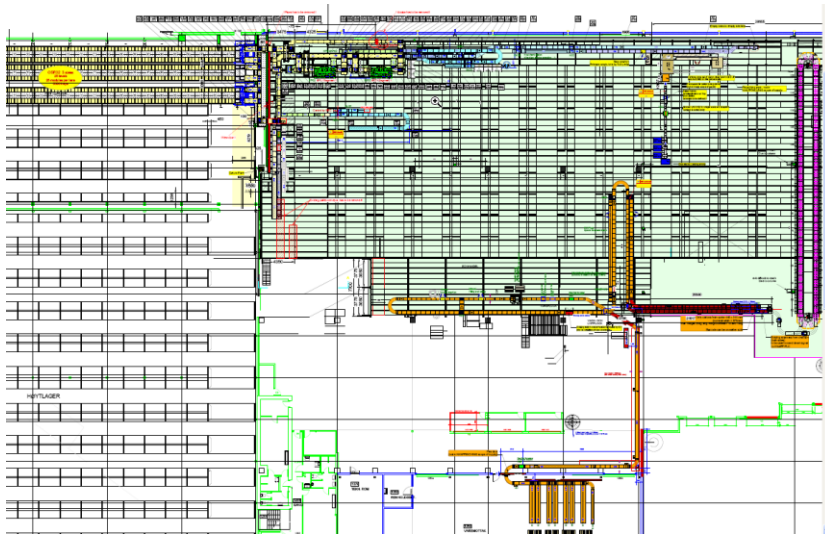

**Production start:**

2010

**Segment:**

Distribution center (books)

**Material handling category:**

OSR, shuttle based storage solution with high speed picking.

**MHE:**

3 aisles with shuttles on each shelf level, conveyor system and end-of-line handling of picked goods, automatic order start. 15.000 locations.

**Host:**

Dynamics Axapta (XML via file transfer)

**Delivered system level:**

2 WCS (OSR and EOL system)

**Data:**

3400 books picked / hour at 2 picking stations.

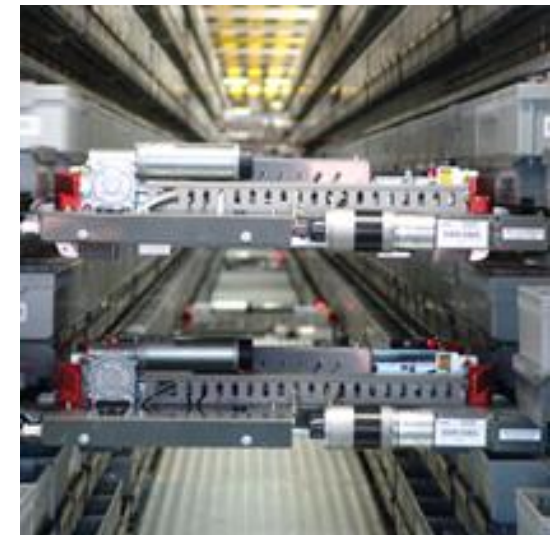

## Infeed stations

- Empty tote conveyors
- Registration of goods
- Compartments used : 1,2,4
- Weight control

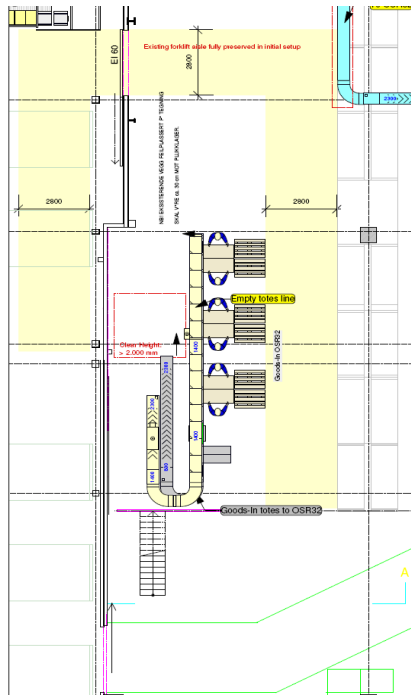

## Picking

- Automatic order start
- Picking is performed to plastic totes
- Picking totes : 1,2,4

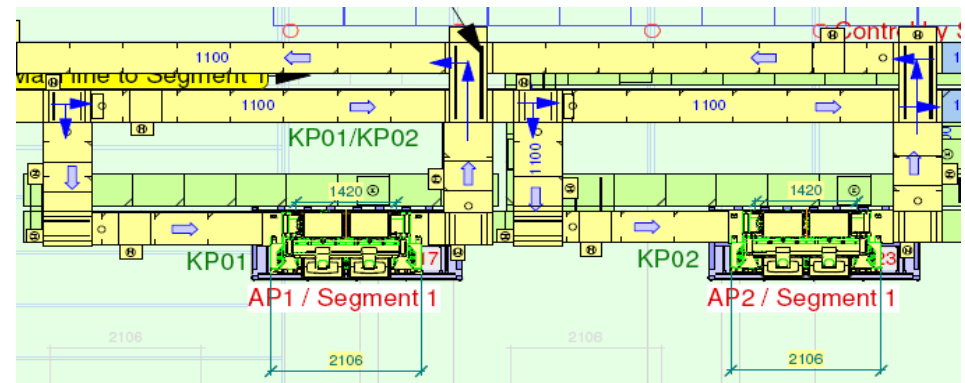
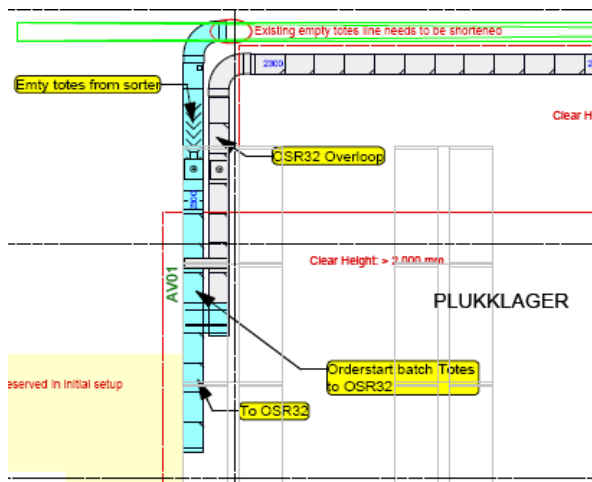

## End of line

- Transport control of picked cartons
- Weight control
- "Value added service"
- Delivery note station
- Sort cartons into shutes depending on tour and delivery time

